

# BONE AND JOINT HOSPITAL<sup>®</sup> at St. Anthony

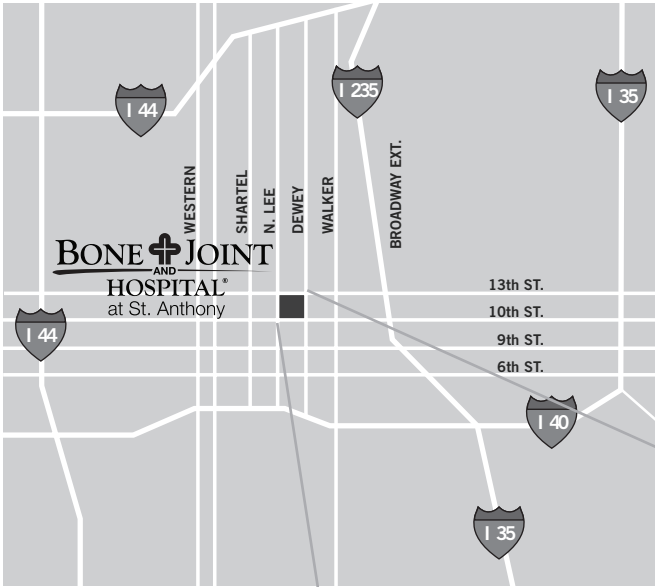

**DRIVING DIRECTIONS:**

Bone and Joint Hospital at St. Anthony is located at 1111 N. Dewey Ave. in Oklahoma City. Our campus is easily accessible from all major thoroughfares in the city.

**Eastbound I-40**

1. Start out going East on I-40 E
2. Take the WESTERN exit – exit #149.
3. Turn LEFT on WESTERN.
4. Continue on WESTERN to NW 10TH ST.
5. Turn RIGHT onto NW 10TH ST.
6. Turn LEFT onto N. DEWEY AVE.

**Westbound I-40**

1. Start out going WEST on I-40 W
2. Take the WESTERN exit – exit #149.
3. Turn RIGHT onto WESTERN.
4. Continue on WESTERN to NW 10TH ST.
5. Turn RIGHT onto NW 10TH ST.
6. Turn LEFT onto N. DEWEY AVE.

**Northbound I-235**

1. Take I-40 Westbound
2. Continue on I-40 WEST to the WESTERN exit – exit #149.
3. Turn RIGHT onto WESTERN.
4. Continue on WESTERN to NW 10TH ST.
5. Turn RIGHT onto NW 10TH ST.
6. Turn LEFT onto N. DEWEY AVE.

**Southbound I-235**

Exit 10TH ST. WEST to DEWEY, turn RIGHT.

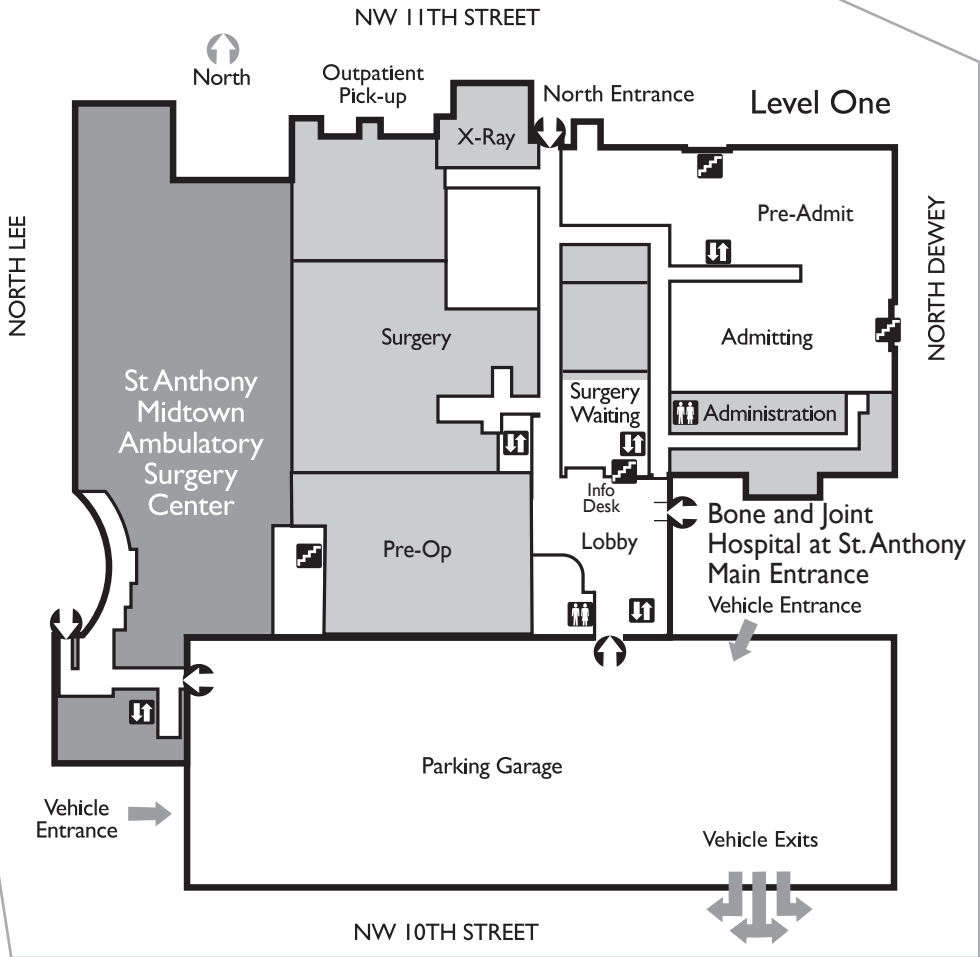

1111 NORTH DEWEY AVENUE  
 OKLAHOMA CITY, OK  
 MAIN PHONE (405) 272-9671  
 PHYSICIAN REFERRAL LINE (405) 272-7900  
 WWW.BONEANDJOINT.COM